

TVL3

series



Product Segments

- **Comfort Motion**
- **Ergo Motion**

The TecHome TVL3 series columns are primarily designed as TV lifts, but can be used in other applications that require vertical movement using a remote control. Our steel constructed TVL3 is available in three sizes depending on the requirements of the application. An extended height position can be programmed using our remote control.

General Features

Maximum load	600N
Maximum speed at full load	22.0mm/s (with 600N in a push condition)
Minimum installation dimension	570mm
Dimension of outer tube (L*W)	120*70mm
Certificate	RoHS
Adjustable stroke (preset in factory)	
Adjustable mounting bracket	

Drawing

Standard Dimensions
(mm)

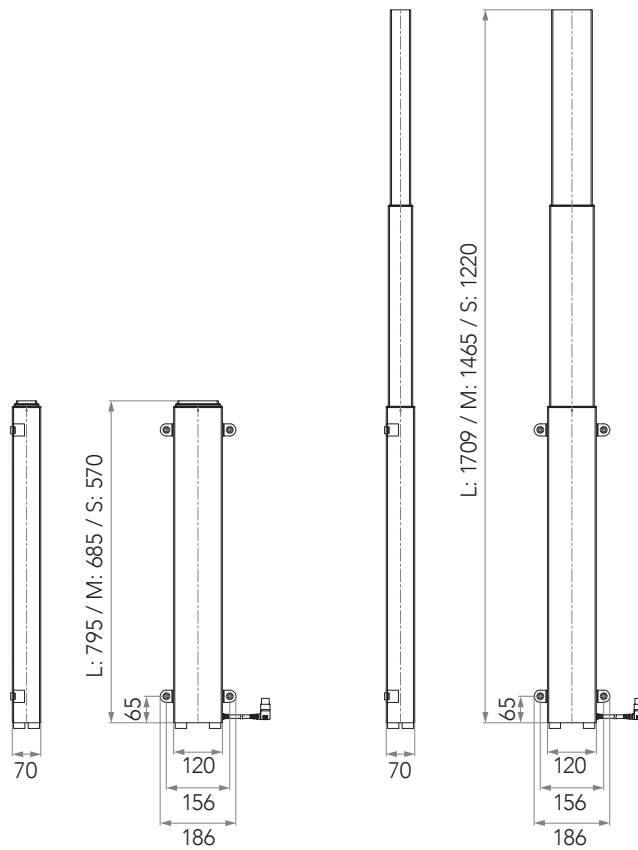

Solution Overview

If you need a complete solution package for TV lift applications, please contact TechHome directly.

Column: TVL3

Control Box: TC11

Controls: TH3 and IR Control



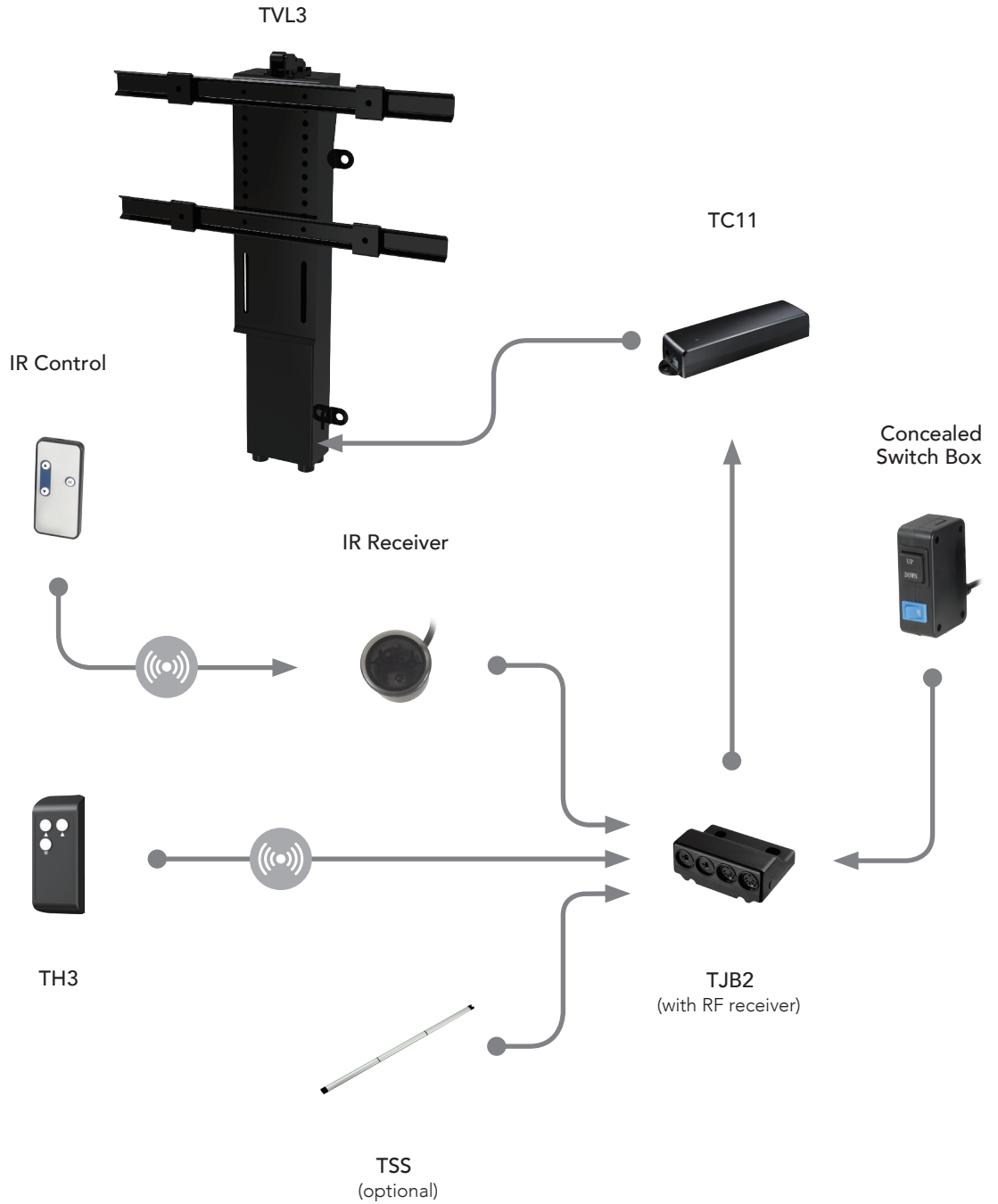



Accessories: TJB2, TSS (optional), IR receiver, and concealed switch box



TVL3 Ordering Key

TVL3

Version: 20150716-B

	Retracted Length (mm)	L = Stroke 914, retracted length 795 M = Stroke 780, retracted length 685	S = Stroke 650, retracted length 570		
	Plug	E = Molex 8pin Note : the cable length of motor is 1350mm			
	Color	1 = Black			
	Accessories Spec	0 = Without	L = "L" type	M = "M" type	S = "S" type
	Logo	0 = Without	1 = TechHomeLogo	A = Customized	
	Packaging	0 = Without		1 = With partition board	

Terms of Use

The user is responsible for determining the suitability of TechHome products for a specific application. TechHome products are subject to change without prior notice.