

FAQ

Q: How many lights can be operated with the TH708 Light Controller?

A: This depends on the current / wattage your lights are. The controller is designed for a total current of 60 watts (for 12v and 5A).
e.g. 10x 6 watt lights or 20x 3 watt lights

Q: What voltage can the controller operate from?

A: The TH708-12 is designed to operate from 12V dc only.

Q: Can the TH708-12 be operated by an existing TecHome remote ?

A: Yes, but it must be a multi-channel remote (model TH701).

Q: Can more than one TH708-12 be used on a multi-channel remote control?

A: Yes, you can add many units onto one or any channel.

Q: What is the warranty on the TH708-12?

A: The TH708-12 has a 12 month warranty, return to supplier (purchaser is responsible for any freight associated costs). See Warranty Statement on the back of this manual.

Proof of Purchase

This warranty is only valid to the original purchaser and is not transferable. Please keep your receipt for warranty purposes, please present your receipt when claiming warranty as proof of purchase date.

Warranty

This product is warranted to be free from any defects for a period of 12 months (one year) from the date of purchase, any defects that may occur will be repaired or replaced.

Warranty Procedure

Please return the faulty product with a valid proof of purchase to the original place of purchase. The customer is responsible for freight, postage and packing costs when claiming warranty.

Exclusions

This warranty does not cover batteries, misuse, packaging, general wear and tear, power surges, lightning strikes, floods, incorrect installation, damage due to lack of care, modifications or repair by unauthorised persons.

Resellers stamp here:



TH708 Light Controller



WIRING AND INSTRUCTION MANUAL

WIRING DIAGRAM

Power supply and lights to be wired to the TH708-12 light controller as follows:

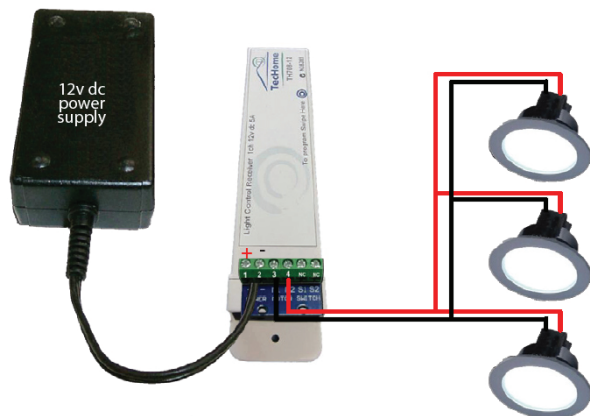

! CONNECTING THE INCORRECT POWER SUPPLY TO THE LIGHT CONTROLLER WILL DAMAGE THE UNIT AND VOID THE WARRANTY

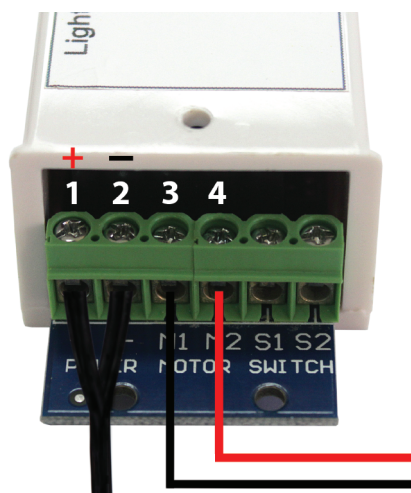

WIRING PINS 1-4

- Pin 1** = 12v dc input
- Pin 2** = Ground
- Pin 3** = DC out to lights
- Pin 4** = DC out to lights

LEARNING REMOTES

1. Connect the power supply and Lights to the controller as per wiring diagram. Turn the power on (unit will beep).

2. Select the channel on the remote that you wish the light to be controlled with.

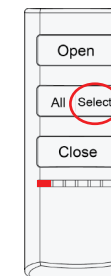

3. Using the back of the remote or a magnet, swipe against the 'SWIPE HERE' mark on the controller. The controller will beep once.

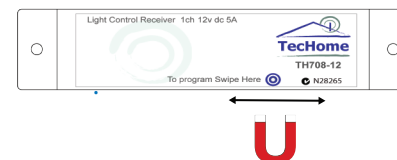

4. Press the open button on the remote control and the controller will give you a few short beeps, indicating it has memorised the remote control.

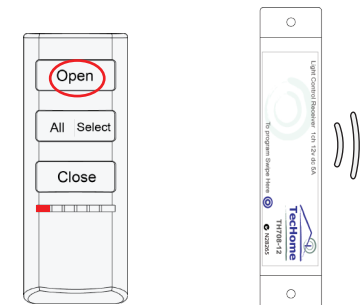

DELETE ALL CONTROLLERS

1. Turn off the power to the controller.



2. Using the back of the remote or magnet, hold near the 'SWIPE HERE' mark and simultaneously turn on the power.

3. The unit will beep for around 10 seconds, then will give you two more short beeps (do not remove until two beeps are heard).

